

BEVERAGE-AIR

**PARTS
MANUAL
FOR
SM/ST/SMF-34/49/58**



ALL PURPOSE COLD ®

**MILK COOLERS
COLD WALL & FORCED AIR**

115V60HZ

| PART | PAGE |
|-------------------------------------|------|
| ACCUMULATORS | 7 |
| CAPILLARY TUBES | 6 |
| CASTERS | 4 |
| COMPRESSOR CAP./ RELAY ASSY. | 6 |
| COMPRESSOR START CAP. | 6 |
| COMPRESSORS | 6 |
| CONDENSER COILS | 7 |
| CONDENSER FAN BLADES | 7 |
| CONDENSER FAN MOTORS | 7 |
| CONDENSING UNITS | 6 |
| DOOR BUMPER-RECESS 1" BLACK | 3 |
| DOOR GASKET ASSEMBLIES | 4 |
| DOOR HINGE BUSHING | 4 |
| DOOR HINGE PIN | 4 |
| DOOR HINGE PLATE | 4 |
| DOOR HINGE RETAINER | 4 |
| DOOR LATCH KEEPER | 4 |
| DOOR LATCH PIN ASSEMBLY | 4 |
| DOOR LATCH SPACER | 4 |
| DOOR LOCK SCREWS | 3 |
| DOOR LOCK SPACERS | 3 |
| DOOR LOCK STRIKE | 3 |
| DOOR LOCK WASHERS | 3 |
| DOOR LOCKS W / KEYS | 3 |
| DOOR STRIKE | 3 |
| DRAIN "O" RING | 4 |
| DRAIN CAP AND WASHER(EXTERIOR) | 4 |
| DRAIN FLANGE | 4 |
| DRAIN HOSE ADAPTER (NYLON) | 4 |
| DRAIN LINE HOOK | 4 |
| DRAIN PAN (EVAPORATOR) | 4 |
| DRAIN PAN HOOK SPRING | 4 |
| DRAIN PAN SPRING HOOK | 4 |
| DRAIN PLUG (EXTERIOR) | 4 |
| DRAIN PLUG (INTERIOR) | 3 |
| DRYERS | 7 |
| EVAPORATOR FAN BLADES | 4 |
| EVAPORATOR FAN MOTORS | 4 |
| EVAPORATOR COIL ASSEMBLIES | 6 |
| EVAPORATOR COILS | 6 |
| LID ASSEMBLIES | 3 |
| LID BUMPER ASSEMBLY | 4 |
| LID CHAIN RETAINER SCREW | 4 |
| LID CHAIN | 4 |
| LID GASKET KITS | 3 |
| LID GASKETS-SEALS | 3 |
| LID HOLDING CLAMP | 4 |
| REFRIGERATION ASSEMBLIES | 6 |
| SHELVING | 4 |
| SUCTION LINE & CAPILLARY ASSEMBLIES | 6 |
| TEMPERATURE CONTROLS | 4 |
| THERMOMETERS (SOLAR & DIGITAL) | 4 |

SMF34/49/58 ILLUSTRATION

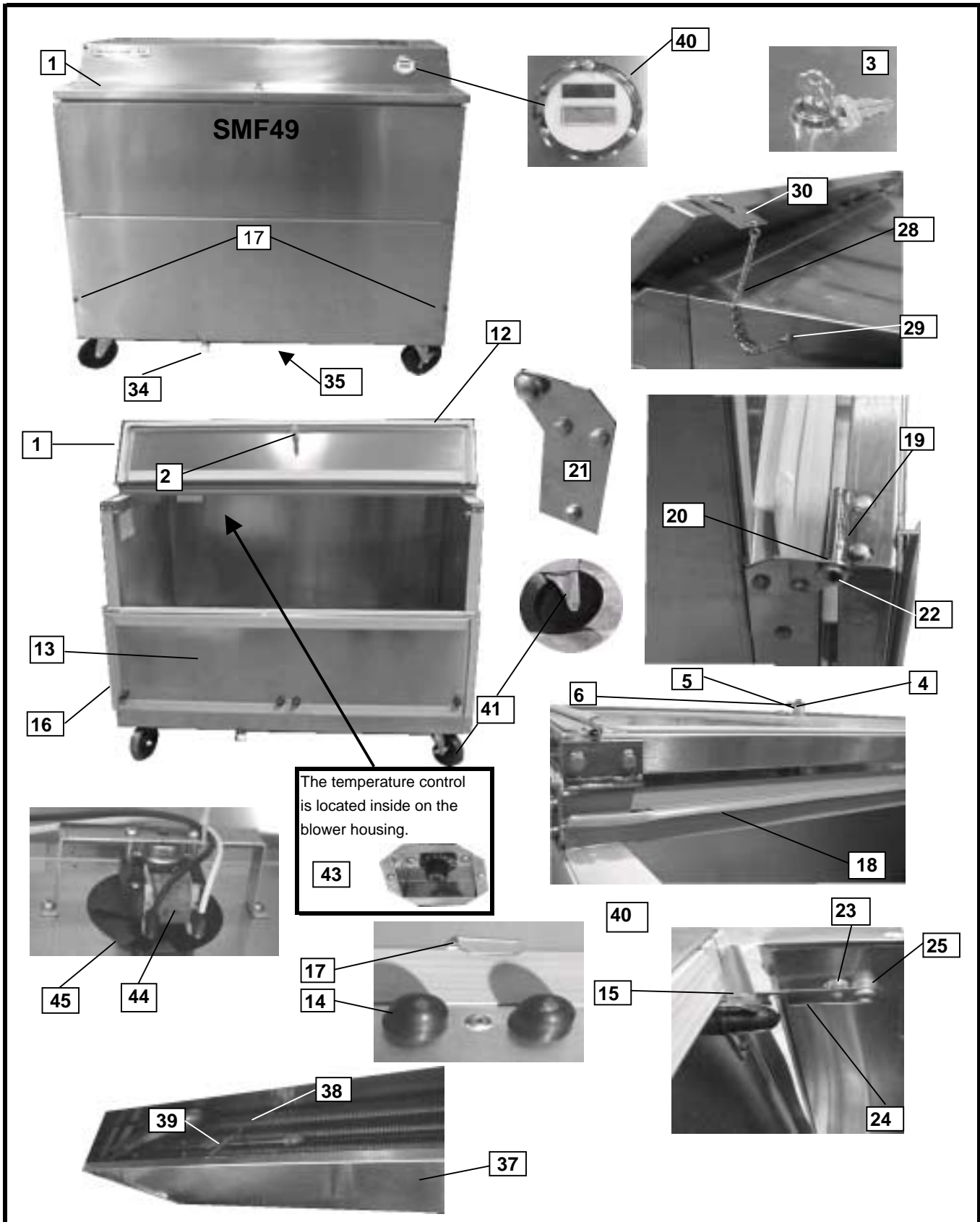

SM-ST34/49/58 ILLUSTRATION

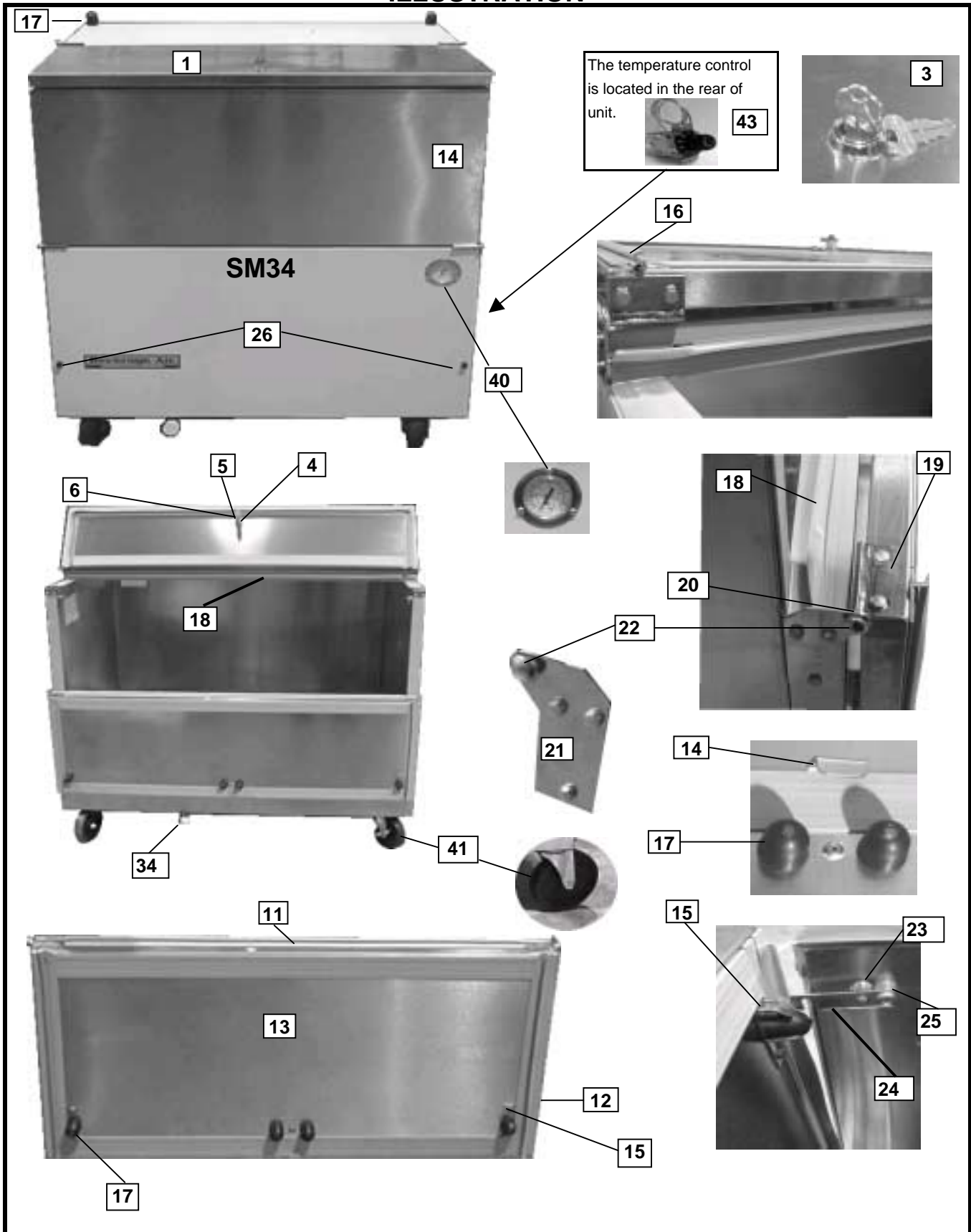

SCHOOL MILK UNITS

DOORS & LIDS

| ITEM | MODEL # | DESCRIPTION | PART NUMBER |
|------|-------------|-----------------------------------|---------------|
| 1 | SM34 | LID ASSEMBLY | 02B33-045C |
| | SM49 | LID ASSEMBLY | 02B33-044C |
| | SM58 | LID ASSEMBLY | 02B33-043C |
| | ST/SMF34 | LID ASSEMBLY | 02B33-050D |
| | ST/SMF49 | LID ASSEMBLY | 02B33-048D |
| | ST/SMF58 | LID ASSEMBLY | 02B33-047D |
| 2 | ALL | LOCK ACCY KIT | 00C30-103A |
| 3 | ALL | LOCK WITH KEYS(2)-#2298 | 401-049AAA |
| 4 | ALL | LOCK EXTENSION NYLON | 401-126A |
| 5 | ALL | LOCK CAM | 401-567A |
| 6 | ALL | LOCK SCREW HHMS 5/16-18 X 1 SM/ST | 603-402A |
| 7 | ALL | CAMLOCK NUT SPACER SM/ST/SMF | 401-480A |
| 8 | ALL | WASHER - NYLON LOCK SPACER | 703-371A-- |
| 9 | ALL | SPACER - LOCK SUPPORT | 703-638A |
| 10 | ALL | HOLE PLUG 1/2 DIA GRAY | 703-645A |
| 11 | SM34 | LID GASKET - SEAL | 02A40-017C |
| | SM49/58 | LID GASKET - SEAL | 02A40-018C |
| | ST/SMF34 | LID GASKET - SEAL | 02A40-020C |
| | SM/ST/SMF58 | LID GASKET- SEAL | 02A40-021C |
| 12 | SM34/49 | GASKET KIT | 32C01-002A |
| | SM58 | GASKET KIT | 32C01-003A |
| | SMF34 | GASKET KIT | 32C01-004A |
| | SMF49 | GASKET KIT | 32C01-005A |
| | SMF58 | GASKET KIT | 32C01-006A |
| 13 | SM/ST/SMF34 | DOOR ASSEMBLY | 02B33-063D-03 |
| | SM/ST/SMF49 | DOOR ASSEMBLY | 02B33-063D-02 |
| | SM/ST/SMF58 | DOOR ASSEMBLY | 02B33-063D-01 |
| 14 | ALL DOORS | DOOR LOCK STRIKE | 02A42-009A |
| 15 | ALL DOORS | DOOR STRIKE | 28D04-028A |
| 16 | ALL DOORS | DOOR GASKET SEAL-DOOR END-L/R | 28D12-009C |
| 17 | ALL DOORS | DOOR BUMPER - RECESS 1"D BLACK | 703-161A-- |

**SCHOOL MILK UNITS
CABINET COPONENTS**

| ITEM | MODEL # | DESCRIPTION | PART NUMBER |
|------|---------------|--------------------------------------|---------------|
| 18 | SM/ST34 | CABINET GASKET ASSY. | 28B36-002ABB |
| | SM/ST49 | CABINET GASKET ASSY. | 28B36-001AAB |
| | SM/ST58 | CABINET GASKET ASSY. | 28B03-002BAA |
| 19 | ALL SM/SMF/ST | HINGE PIN ASSY | 13B01-006A |
| 20 | ALL SM/SMF/ST | HINGE BUSHING | 703-178A-- |
| 21 | ALL SM/SMF/ST | HINGE PLATE (FOR DOOR AND LID) | 28A77-016B |
| 22 | ALL SM/SMF/ST | PUSH ON HINGE RETAINER | 604-167A |
| 23 | ALL SM/SMF/ST | LATCH PIN ASSY. | 603-388A |
| 24 | ALL SM/SMF/ST | DOOR KEEPER LT/RT SS SM/SMF | 28D04-029A |
| 25 | ALL SM/SMF/ST | LATCH SPACER | 401-446A |
| 26 | ALL SM/SMF/ST | BUMPER - RECESS BLACK RUBBER | 703-003A-- |
| 27 | ALL SM | BUMPER ASS'Y | 02B30-007B |
| 28 | SMF34/49/58 | LID CHAIN | 606-001A-- |
| 29 | SMF34/49/58 | LID CHAIN RETAINER SCREW | 603-275A |
| 30 | SMF34/49/58 | LID HOLDING CLAMP | 28D01-013B-05 |
| 31 | ALL SM/SMF | DRAIN PLUG | 703-605A |
| 32 | ALL SM/SMF | DRAIN FLANGE | 205-151A |
| 33 | ALL SM/SMF | "O" RING | 703-379A-- |
| 34 | ALL SM/SMF | DRAIN CAP W/WASHER | 205-144A |
| 35 | ALL SM/SMF | NYLON HOSE ADAPT | 205-143A |
| 36 | SMF 34/49/58 | DRAIN LINE HOOKS | 401-084A-- |
| 37 | SMF34 | EVAP.DRAIN PAN ASSY. | 04B02-106C |
| | SMF49 | EVAP.DRAIN PAN ASSY. | 04B02-107C |
| | SMF58 | EVAP.DRAIN PAN ASSY. | 04B02-094C |
| 38 | SMF34/49/58 | PAN SPRING HOOK | 401-409A |
| 39 | SMF34/49/58 | EVAP. PAN SPRING | 404-414A |
| 40 | SM34/49/58 | DIAL THERMOMETER 2IN DIA. | 402-232B |
| | ALL SMF | THERM. DIGITAL SOLAR | 402-249A |
| 41 | ALL SM | CASTER 4" | 401-094A-- |
| | ALL SM | CASTER 4" W/BRAKE | 401-099A-- |
| | ALL SMF | CASTER 7" | 401-519A |
| | ALL SMF | CASTER 7" W/BRAKE | 401-520A |
| 42 | SM34N | SHELF 30.75X26.63 | 403-221D |
| | SM34L | SHELF 29.75X25.63 | 403-219D |
| | SMF34 | SHELF 27.25X27.63 | 403-400C |
| | SM49N | SHELF 22.75X26.63 | 403-222D |
| | SM49L | SHELF 22.25X25.63 | 403-220D |
| | SMF49 | SHELF 22.25X27.63 | 403-401C |
| | SM58N | SHELF 27.25X26.63 | 403-223D |
| 43 | SM34/49N | TEMPERATURE CONTROL | 502-294B |
| | SM34/49L | TEMPERATURE CONTROL | 502-067ABB |
| | SM58N | TEMPERATURE CONTROL | 502-294B |
| 44 | SMF34/49/58 | EVAPERATOR FAN MOTOR .65 AMPS 120-60 | 501-076B |
| 45 | SMF34/49/58 | EVAPERATOR FAN BLADE 4"(5 PET PLAS) | 405-054A |

REFRIGERATION ASSEMBLY COMPONENTS

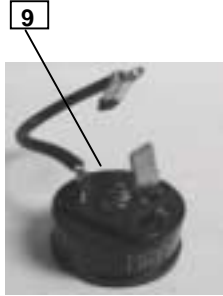
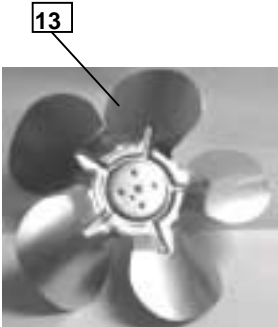
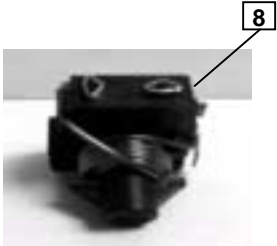
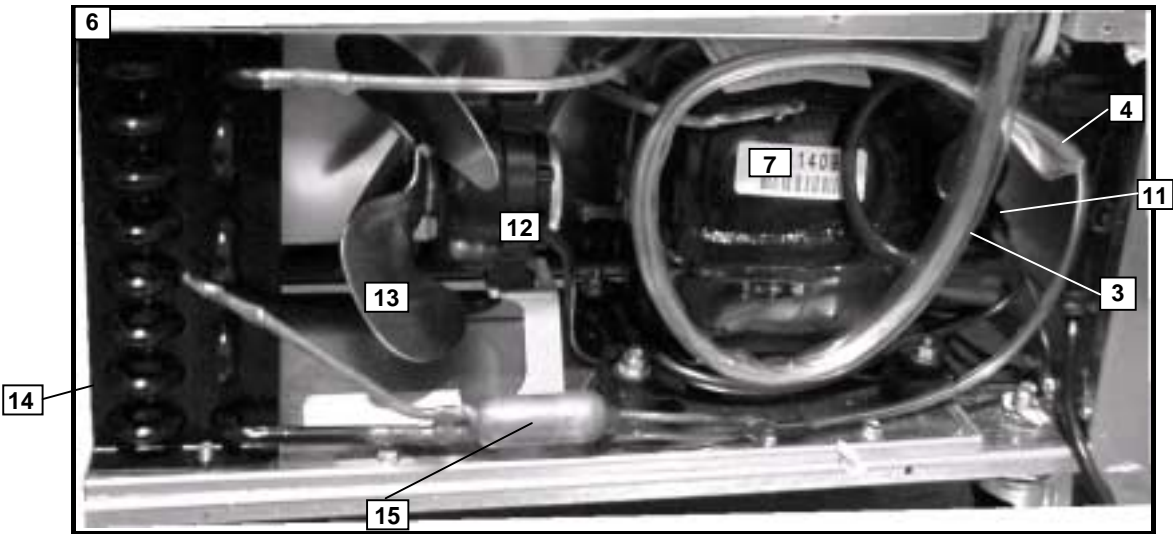

**SCHOOL MILK UNITS
REFRIGERATION ASSEMBLIES**

| ITEM | MODEL # | DESCRIPTION | PART NUMBER |
|------|-------------|---|---------------|
| 1 | SMF34 | REFRIGERATION ASSEMBLY | 19B36-075D-01 |
| | SMF49 | REFRIGERATION ASSEMBLY | 19B36-076D-01 |
| | SMF58 | REFRIGERATION ASSEMBLY | 19B36-077D-01 |
| 2 | SMF34 | EVAPORATOR COIL ASSEMBLY | 20B30-084D |
| | SMF49 | EVAPORATOR COIL ASSEMBLY | 20B30-085D |
| | SMF58 | EVAPORATOR COIL ASSEMBLY | 20B30-086D |
| 3 | SMF34/49/58 | SUCTION LINE AND CAPILLARY ASSY. | 20B33-024C |
| | SM34N | SUCTION LINE AND CAPILLARY ASSY. | 19B30-028D |
| | SM49N | SUCTION LINE AND CAPILLARY ASSY. | 19B30-029D |
| | SM58N | SUCTION LINE AND CAPILLARY ASSY. | 19B30-030D |
| | SM34L | SUCTION LINE AND CAPILLARY ASSY. | 19B30-022D |
| | SM49L | SUCTION LINE AND CAPILLARY ASSY. | 19B30-022D |
| | ST34 | SUCTION LINE AND CAPILLARY ASSY. | 19B30-028D |
| | ST49 | SUCTION LINE AND CAPILLARY ASSY. | 19B30-029D |
| | ST58 | SUCTION LINE AND CAPILLARY ASSY. | 19B30-030D |
| 4 | SMF34/49/58 | CAPILLARY TUBE (.059ID X .109OD X 96) | 203-128A |
| | SM34N | CAPILLARY TUBE (.049ID X .099OD X 116) | 203-041A-- |
| | SM49N | CAPILLARY TUBE (.049ID X .099OD X 80) | 203-117A |
| | SM58N | CAPILLARY TUBE (.054ID X .106OD X 96) | 203-045A-- |
| | SM34L/SM49L | CAPILLARY TUBE (.042ID X .092OD X 108) | 203-138A |
| | ST34 | CAPILLARY TUBE (.049ID X .099OD X 116) | 203-041A-- |
| | ST49 | CAPILLARY TUBE (.049ID X .099OD X 80) | 203-117A |
| | ST58 | CAPILLARY TUBE (.054ID X .106OD X 96) | 203-045A-- |
| 5 | SMF34 | EVAPORATOR COIL (26"X4"X5") | 305-191C |
| | SMF49 | EVAPORATOR COIL (41"X4"X5") | 305-192C |
| | SMF58 | EVAPORATOR COIL (50"X4"X5") | 305-193C |
| 6 | SMF34 | CONDENSING UNIT | 15C32-049D |
| | SMF49/58 | CONDENSING UNIT | 15C32-047D |
| | SM34N | CONDENSING UNIT | 19B34-031D-01 |
| | SM49N | CONDENSING UNIT | 19B34-031D-03 |
| | SM58N | CONDENSING UNIT | 19B34-031D-02 |
| | SM34L | CONDENSING UNIT | 19B34-025D-01 |
| | SM49L | CONDENSING UNIT | 19B34-025D-01 |
| | SM58L | CONDENSING UNIT | 19B34-031D-02 |
| | ST34 | CONDENSING UNIT | 19B34-031D-01 |
| | ST49 | CONDENSING UNIT | 19B34-031D-03 |
| | ST58 | CONDENSING UNIT | 19B34-031D-02 |

SCHOOL MILK UNITS
REFRIGERATION ASSEMBLIES (Continued)

| ITEM | MODEL # | DESCRIPTION | PART NUMBER |
|------|--------------------------------------|--|-------------|
| 7 | SMF49/58 | COMPRESSOR 1/2HP 115-60 TEC. (AKA4476YXA) | 302-626B |
| | SM34/49N | COMPRESSOR 1/4HP 115-60 TEC. (AE9415ZXA) | 312-001B |
| | SM58N | COMPRESSOR 1/3HP 115-60 TEC. (AE9422ZXA) | 312-002B |
| | SM34/49L | COMPRESSOR 1/3HP 115-60 TEC (AEA2411ZXA) | 302-943B |
| | SM58L | COMPRESSOR 1/3HP 115-60 TEC. (AE9422ZXA) | 312-002B |
| | ST34/49 | COMPRESSOR 1/4HP 115-60 TEC. (AE9415ZXA) | 312-001B |
| | ST58 | COMPRESSOR 1/3HP 115-60 TEC. (AE9422ZXA) | 312-002B |
| 8 | SMF34 | COMPRESSOR RELAY (TI) 9660 042 182 | 302-350A |
| | SMF49/58 | COMPRESSOR RELAY (GE) 3ARR2-KCR181S | 302-290A |
| | SM34/49N | COMPRESSOR RELAY (GE) 3ARR12-PL22 | 302-909A |
| | SM58N | COMPRESSOR RELAY (GE) 3ARR12KPL71 | 302-963A |
| | SM34/49L | COMPRESSOR RELAY (GE) 3ARR12KPL71 | 302-963A |
| | SM58L | COMPRESSOR RELAY (GE) 3ARR12KPL71 | 302-963A |
| | ST34/49 | COMPRESSOR RELAY (GE) 3ARR12-PL22 | 302-909A |
| ST58 | COMPRESSOR RELAY (GE) 3ARR12KPL71 | 302-963A | |
| 9 | SMF34 | COMPRESSOR OVERLOAD | 302-350A |
| | SMF49/58 | COMPRESSOR OVERLOAD | 302-439A |
| | SM34/49N | COMPRESSOR OVERLOAD | 302-908A |
| | SM58N | COMPRESSOR OVERLOAD | 313-009A |
| | SM34/49L | COMPRESSOR OVERLOAD | 313-004A |
| | SM58L | COMPRESSOR OVERLOAD | 313-009A |
| | ST34/49 | COMPRESSOR OVERLOAD | 302-908A |
| ST58 | COMPRESSOR OVERLOAD | 313-009A | |
| 10 | SMF49/58 | START CAP. | 302-628A |
| | SM34/49N | START CAP. | 302-357A |
| | SM58N | START CAP. | 315-003A |
| | SM34/49L | START CAP. | 315-003A |
| | SM58L | START CAP. | 315-003A |
| | ST34/49 | START CAP. | 302-357A |
| | ST58 | START CAP. | 315-003A |
| 11 | SMF49/58 | CAP/RELAY ASSY. | 302-718A |
| | SM58N | CAP/RELAY ASSY. | 317-009A |
| | SM34/49L | CAP/RELAY ASSY. | 317-004A |
| | SM58L | CAP/RELAY ASSY. | 317-009A |

SCHOOL MILK UNITS
REFRIGERATION ASSEMBLIES (Continued)

| ITEM | MODEL # | DESCRIPTION | PART NUMBER |
|------|-------------|---|-------------|
| 12 | SMF34/49/58 | CONDENSER FAN MOTOR (9 WATTS 115-60) | 501-148B |
| | SM34N | CONDENSER FAN MOTOR (5 WATTS 115-60) | 501-019B |
| | SM49/58N | CONDENSER FAN MOTOR (9 WATTS 115-60) | 501-148B |
| | SM34/49/58L | CONDENSER FAN MOTOR (9 WATTS 115-60) | 501-148B |
| | ST34 | CONDENSER FAN MOTOR (5 WATTS 115-60) | 501-019B |
| | ST49 | CONDENSER FAN MOTOR (9 WATTS 115-60) | 501-148B |
| | ST58 | CONDENSER FAN MOTOR (9 WATTS 115-60) | 501-148B |
| 13 | SMF34 | CONDENSER FAN BLADE (8.75") | 405-034A |
| | SMF49/58 | CONDENSER FAN BLADE 9.5" (3 PET ALUM) | 405-053B |
| | SM34/49N | CONDENSER FAN BLADE 6.75" (3 PET ALUM) | 405-015A-- |
| | SM58N | CONDENSER FAN BLADE 7.75" (3 PET ALUM) | 405-012A-- |
| | SM34/48/58L | CONDENSER FAN BLADE 7.75" (3 PET ALUM) | 405-012A-- |
| | ST34 | CONDENSER FAN BLADE 6.75" (3 PET ALUM) | 405-015A-- |
| | ST49/58 | CONDENSER FAN BLADE 7.75" (3 PET ALUM) | 405-012A-- |
| 14 | SMF34 | CONDENSER COIL (11"X10"X3") | 305-186C |
| | SMF49/58 | CONDENSER COIL (11"X10-1/64"X4") | 305-194C |
| | SM34N | CONDENSER COIL (11"X10-1/64"X4") | 305-054C |
| | SM49/58N | CONDENSER COIL (11-5/16"X7-7/8"X3") | 305-049C |
| | SM34/49L | CONDENSER COIL (11-5/16X7-7/8X4) | 305-048C |
| | SM58L | CONDENSER COIL (11-5/16X7-7/8X3) | 305-049C |
| | ST34 | CONDENSER COIL (11"X10-1/64"X4") | 305-054C |
| | ST49/58 | CONDENSER COIL (11-5/16X7-7/8X3) | 305-049C |
| 15 | SMF34 | DRYER | 303-143A |
| | SMF49/58 | DRYER | 303-127A |
| | SM34/49/58N | DRYER | 303-143A |
| | SM34/49/58L | DRYER | 303-143A |
| | ST34/49/58 | DRYER | 303-143A |
| 16 | SMF34/49/58 | ACCUMULATOR | 303-071A |